

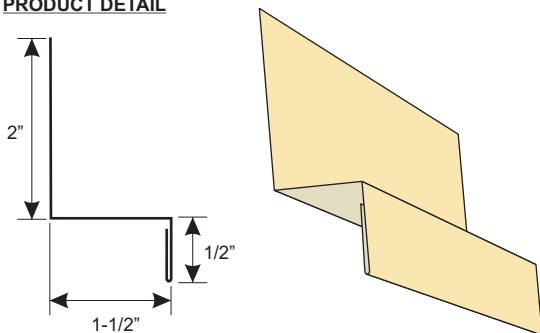

# Tamlyn Color Flashing

## Brick Ledge Flashing

### PRODUCT DETAIL



**Custom sizes available to fit your specifications !**

### DESIGN FEATURES

Brick Ledge Flashing designed to prevent siding and trim to be butted directly against mortar or masonry, including stone and brick.

James Hardie specifies clearances to ensure the long-term durability of their products and the buildings on which they are installed. Failure to provide the proper clearances, as specified below, may affect performance of the building system, violate building codes or James Hardie requirements, and may void any warranty on the products.

### INSTALLATION

Properly flash and space at least 1/4" from horizontal brick ledge or any concrete such as porches, patios, or driveways).

### MATERIAL

3105-type aluminum sheet coated on both sides with Dymalar® 2000 paint system that is specifically formulated for residential exterior applications.

Standard colors shown below. Other colors available upon request.



### INSTALLATION DETAIL

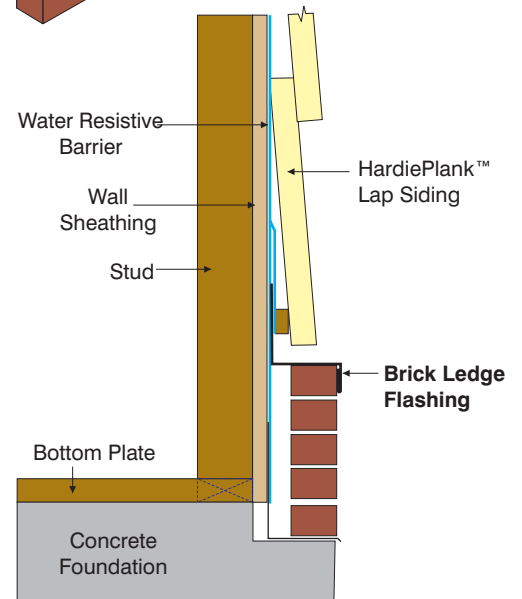
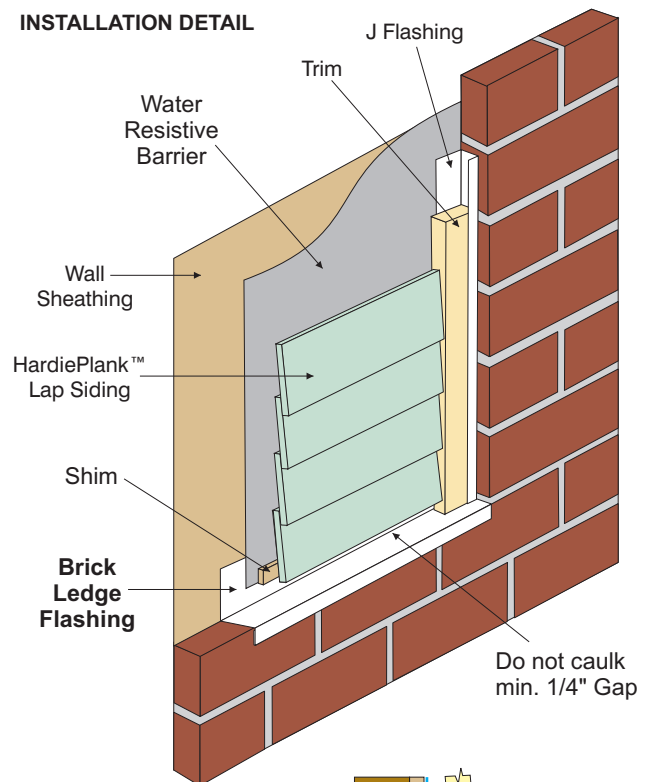

ColorPlus Technology logo, Recommended logo, HardiePanel and HardiePlank are trademarks or registered trademarks of James Hardie International Finance B.V.