



Tamlyn Color Flashing

Plank Flash

Lap Siding Joint Flashing

PRODUCT DETAIL

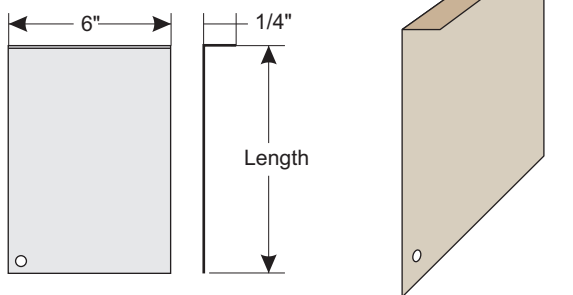

DESIGN FEATURES

Use to prevent moisture from penetrating behind the joint where two planks butt together. Pre-cut for quick and easy installation. Conveniently clips to your belt.

The recommended method for butting factory-finish ends for all HardiePlank® lap siding is moderate contact over a piece of joint flashing. **This method is required for joining ColorPlus® lap siding products.**

Flashing behind butt joints provides an extra level of protection against the entry of water at the joint. James Hardie recommends 6" wide flashing that overlaps the course below by 1". Some local building codes may require different size flashing.

James Hardie does not recommend the use of caulk at field butt joints.

MATERIAL

3105-type aluminum sheet coated on both sides with Dymalar® 2000 paint system that is specifically formulated for residential exterior applications.

Standard colors shown below. Other colors available upon request.



INSTALLATION DETAIL

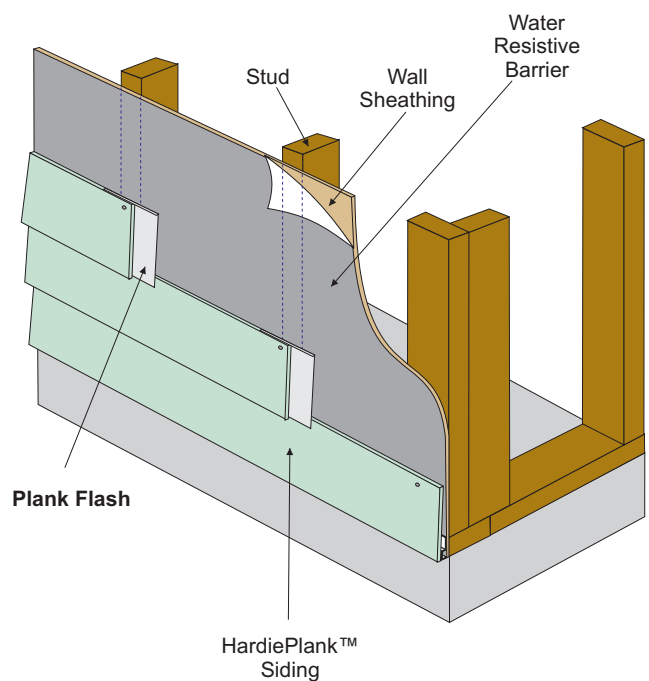

ColorPlus Technology logo, Recommended logo, HardiePanel and HardiePlank are trademarks or registered trademarks of James Hardie International Finance B.V.