

**DESIGN FEATURES**

Produces a clean, durable inside corner for siding panels. The 2-Piece design permits application of the base part first and then installation of the cover cap at a later time. In tight fit situations this may be more convenient than using the standard inside corner. However, due to the natural expansion and contraction of aluminum, all 2-Piece CICLP caps must be secured by adhesive.

Recommended adhesive needs to meet these requirements:

Tensile Strength: ASTM D412 - 475 psi

Lap Shear Strength: ASTM D1002 - 550 psi

**MATERIAL**

6063-T5 .045" ± .005 extruded aluminum alloy with proprietary coating that protects against harsh weather conditions and allows for paint adhesion. For all other finish options refer to page 20.

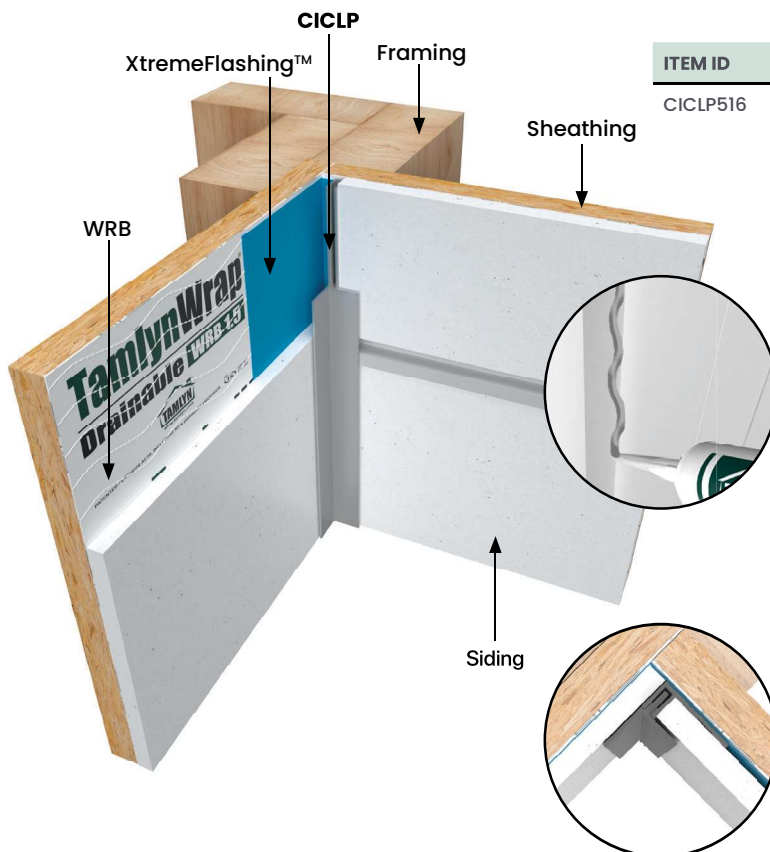
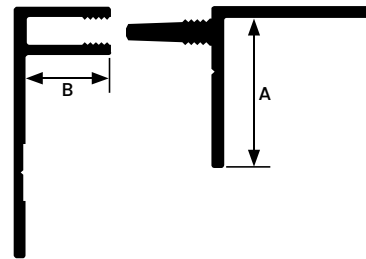

All measurements are nominal

ITEM ID	A	B
CICLP516	5/8"	3/8"

All parts are 10' Length unless otherwise indicated