

TamlynWrap® Elite™ WRB
Method 1: Modified "I"

Tech Support / Sales: 800-334-1676
www.tamlyn.com



- Extend **TamlynWrap® Elite™ WRB** a minimum of **2"** over the foundation ledge.
- **TamlynWrap® Elite™ WRB** should always be lapped in shingle fashion starting from the lowest point. Proper shingling is required to shed water through gravity and to prevent water from entering the wall system.
- Unroll **TamlynWrap® Elite™ WRB** and fasten to sheathing with **cap-fasteners**.
- Fasteners should provide a minimum **1/2"** penetration into the nail base and be spaced approximately **12"** to **18"** apart along the horizontal and vertical laps. Fasten **36"** apart everywhere else.
- Overlap Horizontal and Vertical seams by at least **6"** and corners by **12"**. Stagger vertical seams wherever possible.
- **Optional: Seam Tape**
 - Use **Tamlyn XtremeSeam™ Tape** or standard seam tape for enhanced water and air barrier performance
 - Install seam tape using TAMLYN guidelines.
- Be sure that the wrap installation and flashing allows drainage to the exterior of the assembly.
- Do not allow the wrap to be exposed to sunlight in excess of **120 days**.

***Note:** Use a sharp blade or scissors to cut **TamlynWrap® Elite™ WRB**

Warranty Statement

10 Year Warranty

Tamlyn warrants that warrants that **TamlynWrap® Elite™ WRB** when installed in accordance with the applicable Tamlyn® installation instructions, are free from manufacturing defects for ten (10) years from the date of purchase

TamlynWrap[®] Elite™ WRB
Method 1: Modified “I”

Tech Support / Sales: 800-334-1676
www.tamlyn.com

1. Rough Opening

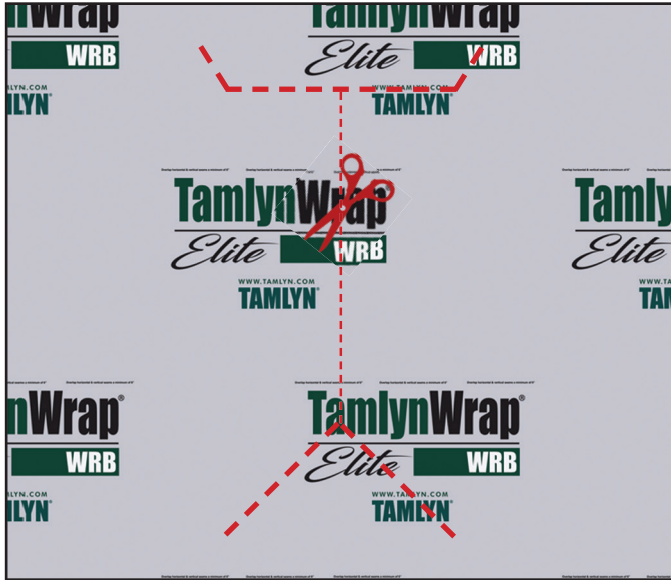

FIG 1:

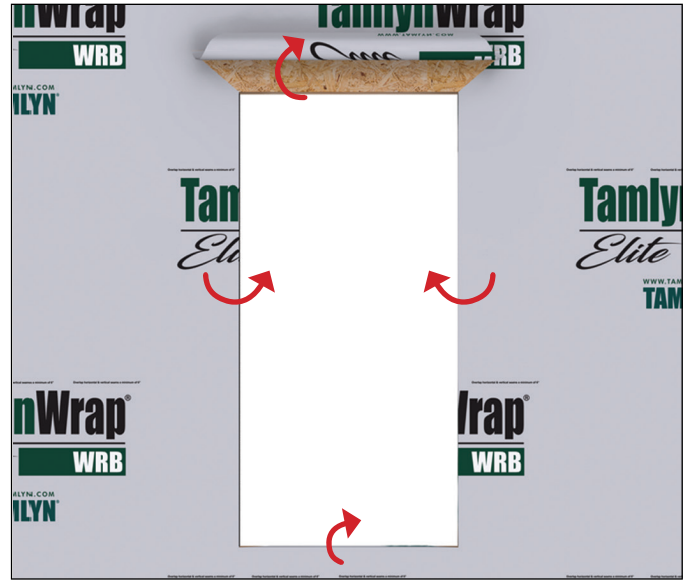

FIG 2:

- Cut **TamlynWrap[®] Elite™ WRB** as shown in **(FIG 1)**.
- Fasten the tabs at the sill and the jambs inward. Fold up the tabs at the window head, and tuck it out of the way as shown in **(FIG 2)**.

2. Sill Flashing



FIG 3:



FIG 4:



FIG 5:

- Install **XtremeFlashing™** min 3” below sill and across front of WRB. Cut a slit in **XtremeFlashing™** along jamb and adhere remainder along sill. **(FIG 3)**.
- Flash both corners with Bow-Tie or corner piece. **(FIG 4)**.
- Adhere additional piece of flashing to fully cover sill and extend up jambs a min of 6”. Flashing should extend to the inside edge of sill. Slit remaining **XtremeFlashing™** at the corner and adhere to the exterior of the wall **(FIG 5)**

NOTE: Use min 6” wide flashing for 2x4 framing. Use 9” wide flashing for 2x6 framing

***Always use roller or hand applicator when installing tapes.**

TamlynWrap[®] Elite™ WRB
Method 1: Modified "I"

Tech Support / Sales: 800-334-1676
www.tamlyn.com

3. Sealant



FIG 6:

- Apply **XtremeSealant™** to the jambs and head of the window before installing. **Never apply the sealant at the bottom of the sill (FIG 6).**

4. Set Window



FIG 7:

- Set the window into the rough opening, level, and fasten to the substrate per window manufacturer's recommendation. Sill Flashing should be visible below the sill flange. Do not apply **XtremeFlashing™ Tape** over the bottom flange. This area is left open to allow water to drain in the event of a window leak. **(FIG 7).**

TamlynWrap[®] Elite[™] WRB
Method 1: Modified "I"

Tech Support / Sales: 800-334-1676
www.tamlyn.com

5. Jamb Flashing



FIG 8:

- Adhere vertical sections with **XtremeFlashing[™] Tape** over the jamb flanges. Extend vertical flashing approximately 3" above the window head and below sill flashing as shown in **(FIG 8)**

6. Head Flashing

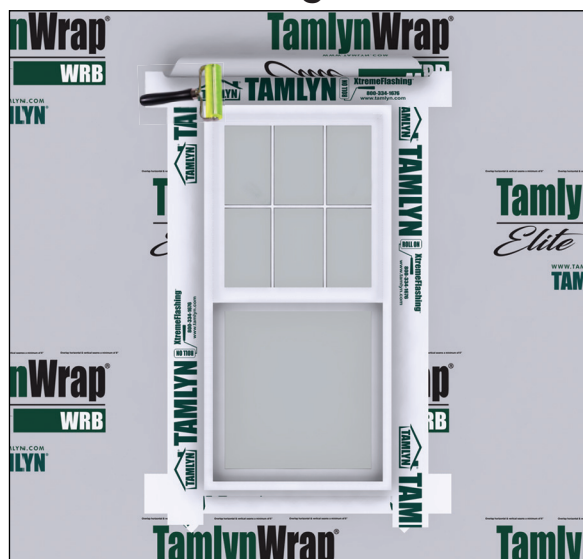

FIG 9:

- Adhere **XtremeFlashing[™] Tape** to the head flange and to the sheathing. Head flashing must extend beyond jamb flashing on either side. Jamb flashing should not extend above the head flashing. **(FIG 9)**.

TamlynWrap[®] Elite™ WRB
Method 1: Modified "I"

Tech Support / Sales: 800-334-1676
www.tamlyn.com

7. FINAL STEPS

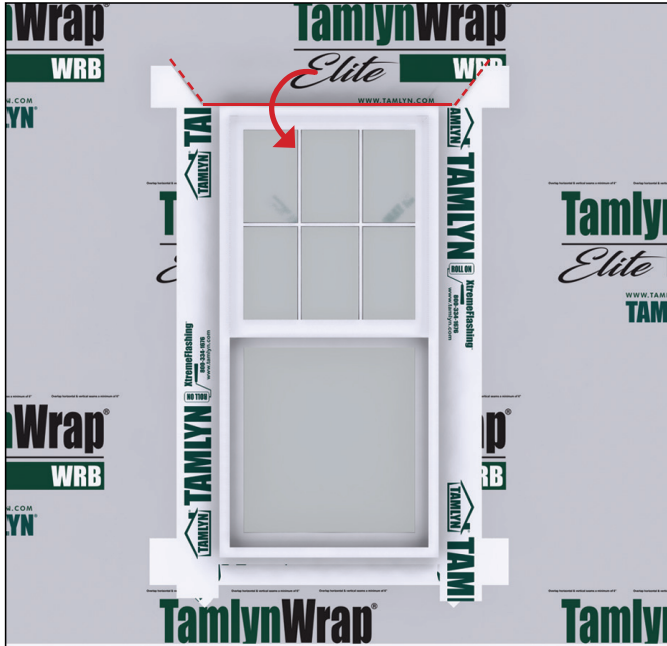

FIG 10:

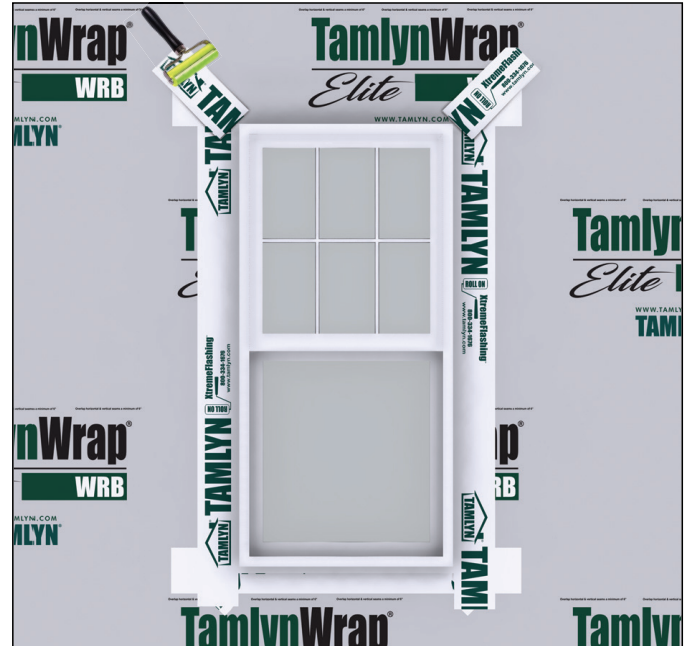

FIG 11:

- Fold the top tab of **TamlynWrap[®] Elite™ WRB** over the head section as shown in (**FIG 10**).
- Tape corners using **XtremeFlashing™ Tape** as shown in (**FIG 11**).

Note: For best results, apply a continuous bead of sealant to the interior side of the window. Consult Tamlyn for additional methods and detailing.